

# The Parts Book

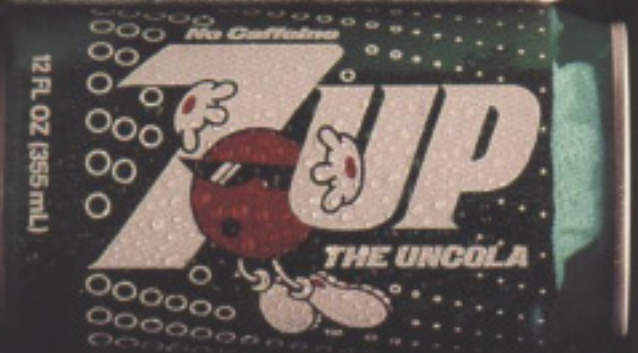

# Refrigeration System

Can Display, Cold Drink FL5, Dr Pepper (D3), Generic Round, 7Up IB71, Veryfine Circular0001-319400 to 0001-618945; Veryfine-RC Inverted "L" Circular

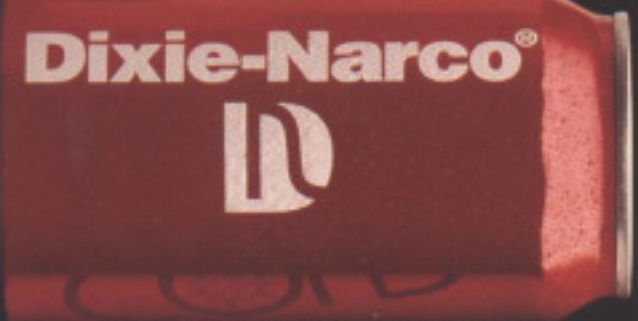
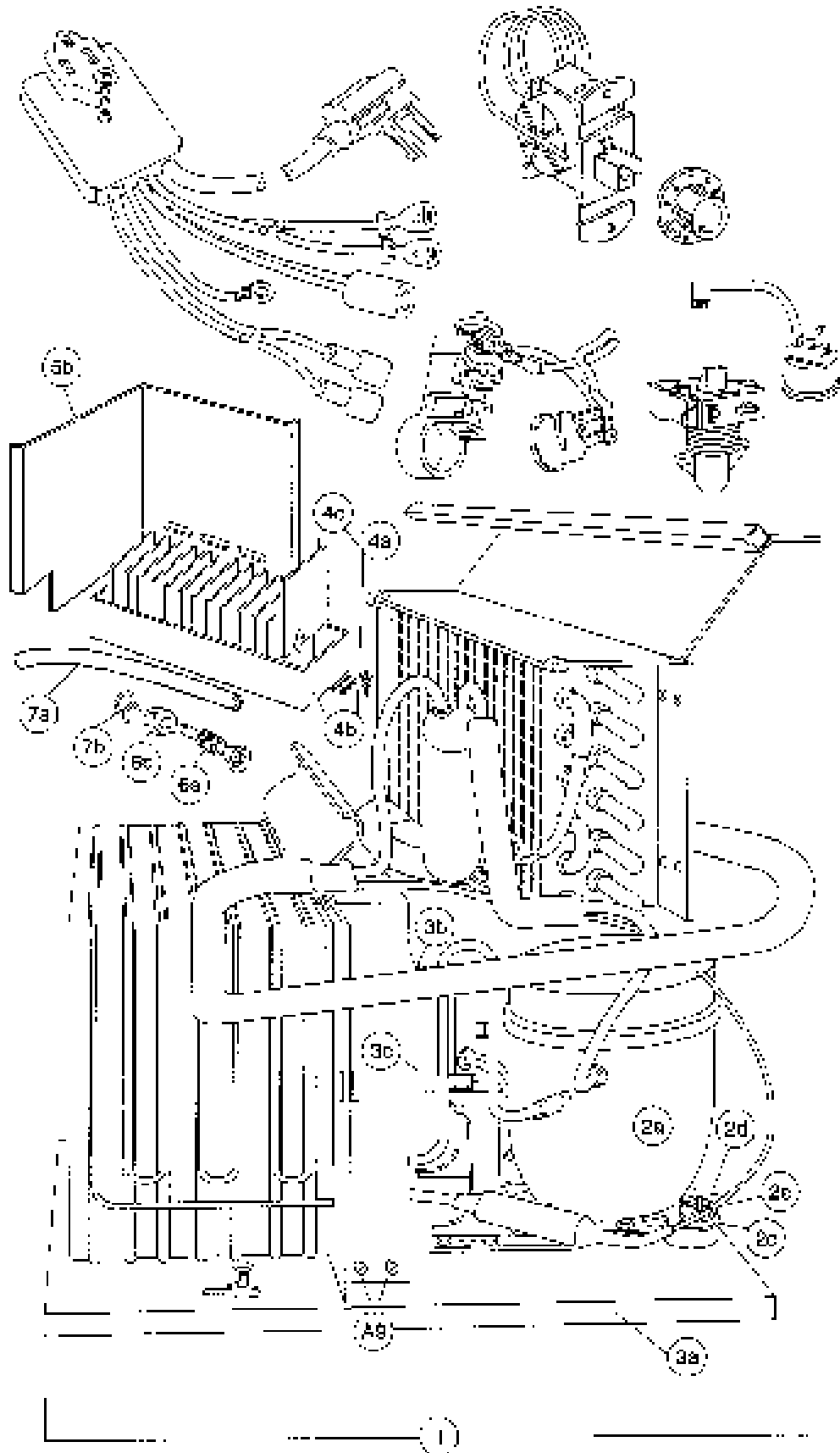

Car Display, Cold Drink FLS, Dr Pepper (D3), Generic Round, 7Up (E37),  
 Veryfine Circular(D3)-315420 to 3201-31693; Veryfine/RC Inverted 'L' Circular

Item	Part Number	Part Name And Description By Model Number
1	Provide information listed	Complete 5 1/3 HP Refrigeration System: 501/600 Indicate unit model number from serial plate on unit base plate, refrigerant, voltage/hertz and country.
	Provide information listed	Complete 1/3 HP Refrigeration System: 348/360/368/414/432/440 Indicate unit model number from serial plate on unit base plate, refrigerant, voltage/hertz and country.
	Provide information listed	Complete 1/4 HP Refrigeration System: 276 Indicate unit model number from serial plate on unit base plate, refrigerant, voltage/hertz and country.
2a	Provide information listed	Compressor 5 1/3 HP: Indicate compressor manufacturer, voltage/hertz, refrigerant and complete manufacturer's model number.
	Provide information listed	Compressor 1/3 HP: Indicate compressor manufacturer, voltage/hertz, refrigerant and complete manufacturer's model number.
	Provide information listed	Compressor 1/4 HP: Indicate compressor manufacturer, voltage/hertz, refrigerant and complete manufacturer's model number.
2b		Compressor Lead Harness (not shown) All, Except EC Standers
	904,900,611,11	5 1/3 HP & 1/3 HP 220-240v/50hz, Europe
	904,905,340,21	1/4 HP 220-240v/50hz, Europe
2c		Compressor Mounting Grommet
	902,000,670,11	All Models
2d		Compressor Mounting Retainer Clip
	900,901,890,11	All Models
2e		Compressor Grommet, Plug Plastic
3a	901,803,910,11	All Models
	491,040,040,85	Condenser Base Plate, 1/4 & 1/3
3b		Condenser Fan Motor Assembly
	491,040,200,03	115V - All Models
	491,140,300,03	220-240V
3c		Condenser Fan Motor
	904,500,670,21	115V - All Models
	904,500,700,31	220-240V - All Models
3d	800,103,970,02	Fan Blade, Condenser All Models
4a	491,000,100,23	Drain Pan Assembly w/ Fiberglass Sockets All Models
	901,904,240,11	Drain Pan, Plastic with Fingers All Models
4c	905,801,690,11	Socket, Fiberglass (14 required) All Models
5a	491,040,050,73	Condenser Baffle, Right Side Wide Venders (not shown)
	493,040,030,53	Narrow Venders
		Condenser Baffle, Front
5b	497,040,060,33	501/600
	491,040,080,93	360/348/398/414/432/440
	493,040,040,43	160/276
6a	801,906,050,21	Drain Tube All Models
	900,301,790,01	Drain Tube Nut All Models
7a	901,901,500,11	Drain Hose All Models
	900,801,030,01	Drain Hose Clamp All Models

Continued next page

# Refrigeration System

Can Display, Cold Drink FL5, Dr Pepper (D3), Generic Round, 7Up (B7).  
Veryfine Circular,0031-370470 to 3001-819943; Veryfine/RC Inverted, L' Circular

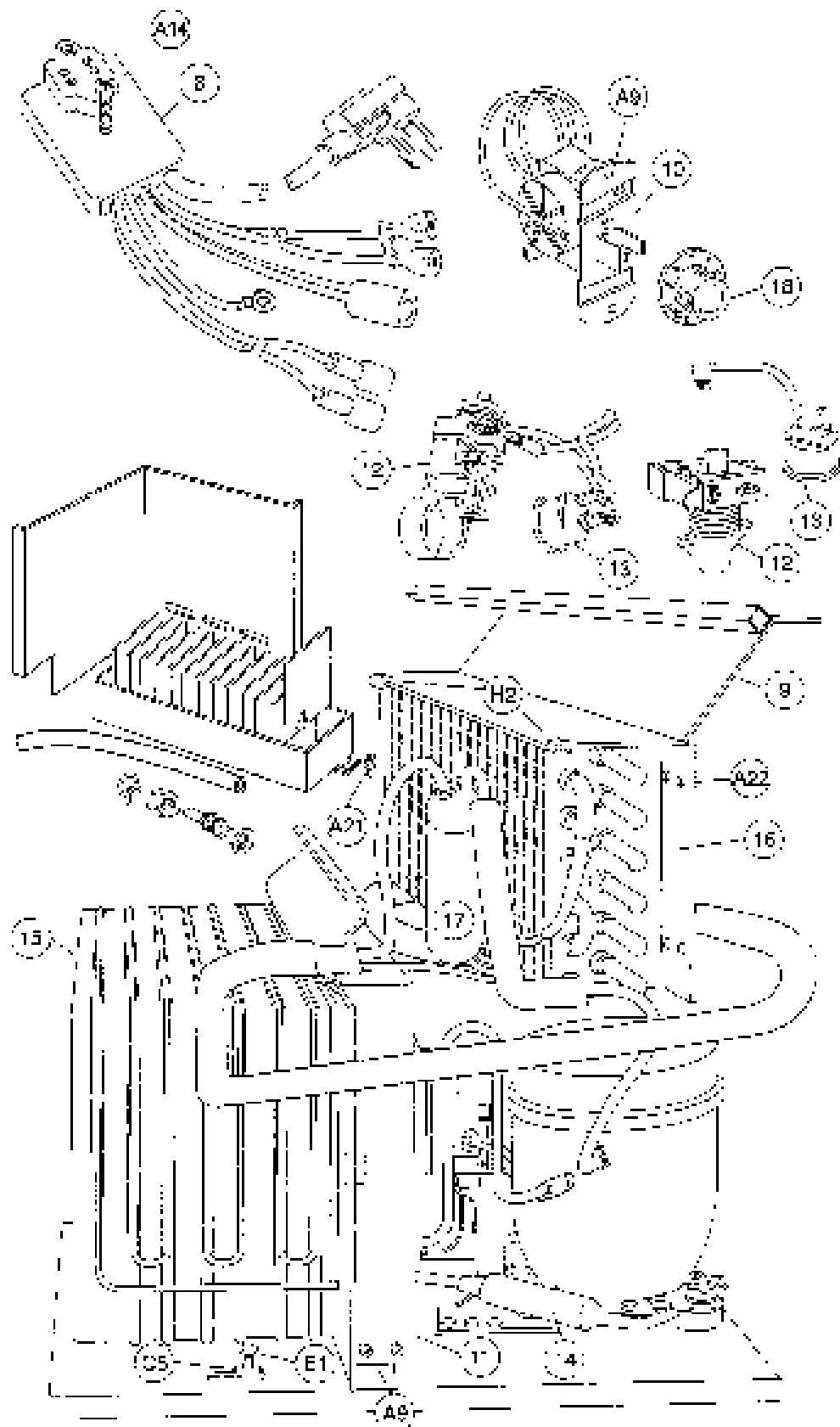

Parts List - Refrigeration System

Dixie-Morco

Can Display, Cold Drink FLS, Dr Pepper (D3) Generic Round, 7Up (B7), Veryfine Circular (D001-2800) to (D001-5800), Veryfine/BC Inverted 'L' Circular

Item	Part Number	Part Name And Description By Model Number
a	Main Wiring Harness	
	804,902,220.E1 (a)	United States & Mexico
	804,902,140.71 (b)	Australia, IEC 335
	804,905,490.1 (c)	United Kingdom, Ireland, IEC 335
	804,902,150.21 (d)	Europe, Italy, Korea, & Paris, France
	804,905,470.1 (e)	Denmark, IEC 335
	804,905,360.D1 (f)	Germany, Spain, Italy, France, Holland, Poland, Switzerland, & Greece w/ Splashwater Protector
7	Top Fan Housing	
	228,040,330.09	Long - T-Model Venders
	211,040,030.13	Short - Wide Venders
	143,040,511.32	Narrow Venders
10	Temperature Control:	
	603,800,410.1*	All Models
11	Fan Shroud Condenser	
	491,040,110.45	All Models
12	Provides information listed	Relay (Indicates compressor manufacturer, model #, and voltage/hz.)
13	Provides information listed	Overload (Indicates compressor manufacturer, model #, and voltage/hz.)
14	Dryer, Extended Outlet:	
	802,401,230.11	31/8 HP (R12)
	802,401,240.11	1/3 HP (R12)
	802,401,250.11	1/4 HP (R12)
15	Condenser:	
	802,600,540.0*	3 1/8 HP, "A" (T-model)
	802,600,550.0*	1/3 HP "B"
	802,600,560.0*	1/4 HP "C"
16	Evaporator	
	802,600,370.0*	Short
	802,600,500.11	Long
17	Accumulator:	
	802,400,480.2*	All Models
18	Knob, Temperature Control	
	802,600,420.21	All Models
A21	900,301,900.01	Screw, Phil Pan Shoulder #8 - 1/8 x 17.32"
A22	900,301,840.0*	Screw, Phil Pan #8 x 1/2"
A9	900,301,520.11	Screw, Phil Pan Swage Form #9 - 3/32 x 3/8"
A14	900,301,810.2*	Screw, Phil Pan Form #10 - 3/32 x 1/2"
C5	900,700,350.0*	Lockwasher, Spdt. 3/8"
H2	900,301,950.0*	Tinerman Clip
E1	900,400,440.0*	Refrigeration Sol, 3/8-16 x 1"